



MARTINS ESTATES

SALES AND LETTINGS

Martins Estates Sales And Lettings High Street
Ashford
Kent
TN24 8SF

Tel: 01233610444



113 Highfield Road, Ashford, Kent TN24 0LN

Asking Price £269,000

A well-presented two-bedroom semi-detached house on the popular Highfield estate. The property consists of an entrance doorway into the entrance porch with a door leading into the lounge with a window overlooking the front of the property. Stairs to the first floor landing with wood effect flooring and door to the well-fitted kitchen with work surfaces on three sides, fitted oven, and space for automatic washing machine. On the first floor, there are two well-appointed bedrooms and a family bathroom the property has a lovely rear garden and off-road parking to the front for several vehicles. No pets will be accepted. Located in the popular Highfield development, this two-bedroom property is close to Willesborough's parade of shops and the local school. There is also the sunny enclosed garden at the rear with allocated parking to the side.

The porch has a UPVC front door and another door leading into the lounge.

LOUNGE 17' 06" x 13' (5.33m x 3.96m) A double-glazed window looks out to the front while the staircase leads upstairs.

KITCHEN/DINER 12' 11" x 8' 10" (3.94m x 2.69m) The kitchen area has a variety of fitted units and space for domestic appliances. A door leads out to the rear garden, and a double-glazed window opens onto the rear of the property.

LANDING With access to all of the bedrooms and the family bathroom.

BEDROOM 13' x 8' 11" (3.96m x 2.72m) The bedroom has a double-glazed window to the front and has carpet laid with a fitted mirrored sliding wardrobe.

BEDROOM 13' x 9' (3.96m x 2.74m) The double-glazed window looks over the back garden. A handy storage cupboard in the corner acts as a fitted wardrobe with storage and a hanging rail.

BATHROOM 9' 06" x 4' 09" (2.9m x 1.45m) The three-piece white suite is modern in design. A frosted double-glazed window gives light and ventilation.

GARDEN The rear garden

113 Highfield Road, Ashford, Kent TN24 0LN

Ground Floor

Approx. 34.2 sq. metres (368.5 sq. feet)

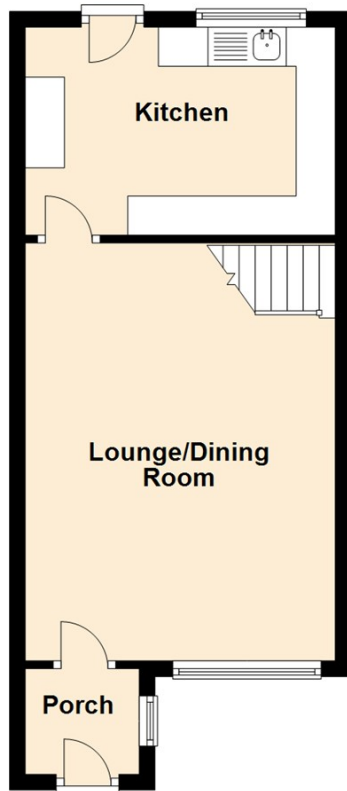

First Floor

Approx. 31.2 sq. metres (336.1 sq. feet)

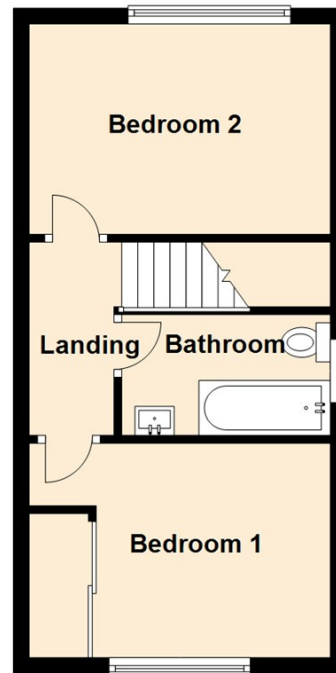

Total area: approx. 65.5 sq. metres (704.5 sq. feet)

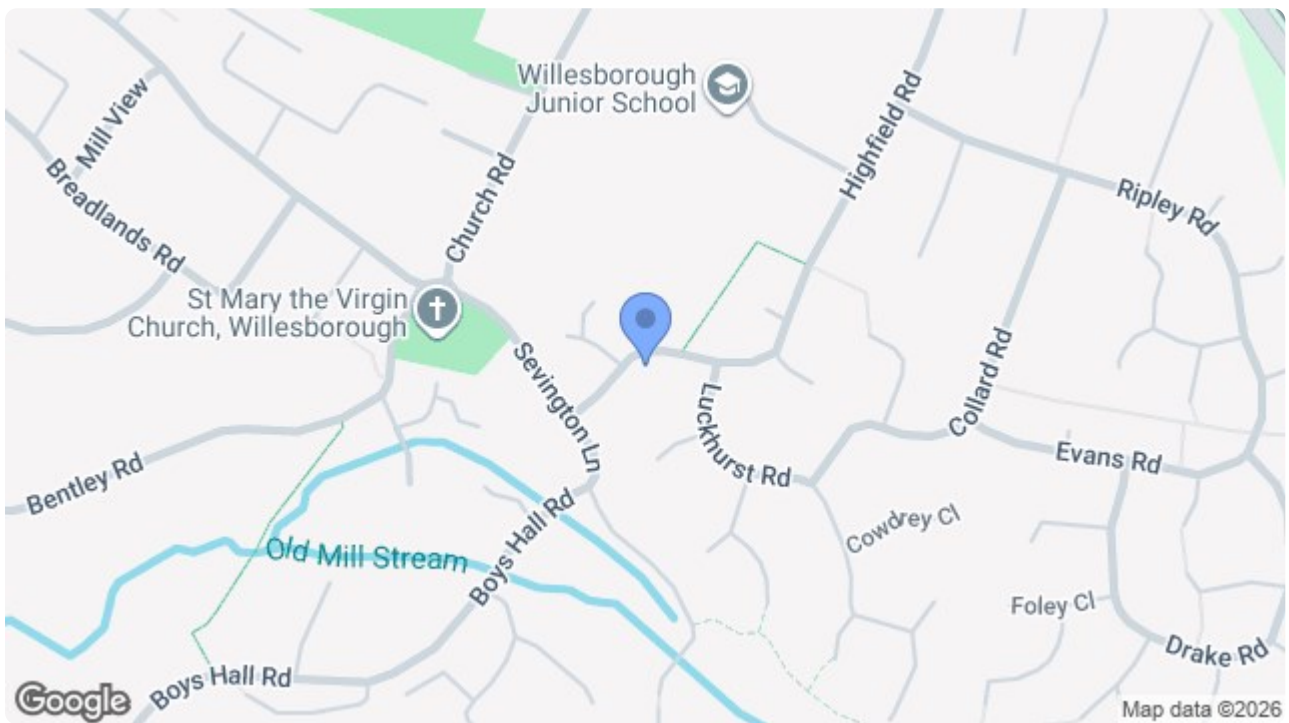

Energy Efficiency Rating		Current	Potential
Very energy efficient - lower running costs			
(92 plus) A			89
(81-91) B			
(69-80) C			72
(55-68) D			
(39-54) E			
(21-38) F			
(1-20) G			
Not energy efficient - higher running costs			
England & Wales		EU Directive 2002/91/EC	

Environmental Impact (CO ₂) Rating		Current	Potential
Very environmentally friendly - lower CO ₂ emissions			
(92 plus) A			
(81-91) B			
(69-80) C			
(55-68) D			
(39-54) E			
(21-38) F			
(1-20) G			
Not environmentally friendly - higher CO ₂ emissions			
England & Wales		EU Directive 2002/91/EC	

69 HIGH STREET, ASHFORD, KENT TN24 8SF

Tel: 01233 610444

www.martineestates.co.uk

email: sales@martineestates.co.uk



Martine Estates Property Management Ltd
Registered in England and Wales No. 10831401
Registered office: 69 High Street, Ashford, Kent, TN24 8SF
Martins Wilkins T/A Martins Estates Sales and Lettings